

Cambridge Waste Water Treatment Plant Relocation Project
Anglian Water Services Limited

Hedgerow Regulations and Tree Preservation Order Plans

Application Document Reference: 4.8
PINS Project Reference: WW010003
APFP Regulation No. 5(2)o

Revision No. 01
April 2023

Document title	Hedgerow Regulations and Tree Preservation Plans
Version No.	C01
Date Approved	28.01.23
Date 1st Issued	30.01.23

Version History

Version	Date	Author	Description of change
C01	30.01.23	-	DCO Submission



Contents

1	Introduction	1
----------	---------------------------	----------

Tables

	Table 1-1: Schedule of plans in this application document.....	1
--	---	----------

1 Introduction

- 1.1.1 The Hedgerow Regulations and Tree Preservation Plans (the Plans), listed in Table 1.1, relate to an application made by Anglian Water Services Limited (the “Applicant”) under section 37 of the Planning Act 2008 (the “2008 Act”) for a Development Consent Order (DCO) for the Cambridge Waste Water Treatment Plant Relocation Project.
- 1.1.2 The Plans are included in the DCO application in compliance with Regulations 5(2)(l) and 5(2)(o) of the Infrastructure Planning (Applications: Prescribed Forms and Procedure) Regulations 2009 (the “2009 Regulations”), which require:
 - “5(2) The application must be accompanied by—*
 - (l) where applicable, a plan with accompanying information identifying—*
 - (ii) habitats of protected species, important habitats or other diversity features;*
 - (o) “any other plans, drawings and sections necessary to describe the proposals for which development consent is sought, showing details of design, external appearance, and the preferred layout of buildings or structures, drainage, surface water management, means of vehicular and pedestrian access, any car parking to be provided, and means of landscaping;”*
- 1.1.3 For ease of cross referencing, the drawing sheets been provided with the same sheet layout, including Inset Plans and even where a particular sheet might not be relevant to a set of plans, for the following application documents: General Arrangement Plans (Application Document Reference 4.2), Works Plans (Application Document Reference 4.3), Rights of Way Plans (Application Document Reference 4.6), Access & Traffic Regulation Order Plans (Application Document Reference 4.7), and Hedgerow and Tree Preservation Order Plans (Application Document Reference 4.8).
- 1.1.4 As these Plans are part of the application documentation, they should be read alongside and are informed by the other application documentation. In particular, these Plans should be read alongside Schedule 15 (Removal of Hedgerows) of the Draft Development Consent Order (Application Document Reference 2.1) and the Works Plans (Application Document Reference 4.3).

Table 1-1: Schedule of plans in this application document

Application Document Ref	Document Title	Drawing Number	Revision	Status
4.8.0	4.8.0 Hedgerow Regulations and Tree Preservation Plans - Key Plan	00001-100006-CAMEST-ZZZ-LAY-Z-9820	CO1	S4

Application Document Ref	Document Title	Drawing Number	Revision	Status
4.8.1	4.8.1 Hedgerow Regulations and Tree Preservation Plans – Sheet 1	00001-100006-CAMEST-ZZZ-LAY-Z-9021	CO1	S4
4.8.2	4.8.2 Hedgerow Regulations and Tree Preservation Plans – Sheet 2	00001-100006-CAMEST-ZZZ-LAY-Z-9022	CO1	S4
4.8.3	4.8.3 Hedgerow Regulations and Tree Preservation Plans – Sheet 3	00001-100006-CAMEST-ZZZ-LAY-Z-9023	CO1	S4
4.8.4	4.8.4 Hedgerow Regulations and Tree Preservation Plans – Sheet 4	00001-100006-CAMEST-ZZZ-LAY-Z-9024	CO1	S4
4.8.5	4.8.5 Hedgerow Regulations and Tree Preservation Plans – Sheet 5	00001-100006-CAMEST-ZZZ-LAY-Z-9025	CO1	S4
4.8.6	4.8.6 Hedgerow Regulations and Tree Preservation Plans – Sheet 6	00001-100006-CAMEST-ZZZ-LAY-Z-9026	CO1	S4
4.8.7	4.8.7 Hedgerow Regulations and Tree Preservation Plans – Sheet 7	00001-100006-CAMEST-ZZZ-LAY-Z-9027	CO1	S4
4.8.8	4.8.8 Hedgerow Regulations and Tree Preservation Plans – Sheet 8	00001-100006-CAMEST-ZZZ-LAY-Z-9028	CO1	S4
4.8.9	4.8.9 Hedgerow Regulations and Tree Preservation Plans – Sheet 9	00001-100006-CAMEST-ZZZ-LAY-Z-9029	CO1	S4
4.8.10	4.8.10 Hedgerow Regulations and Tree Preservation Plans – Sheet 10	00001-100006-CAMEST-ZZZ-LAY-Z-9030	CO1	S4

LEGEND

- SCHEME ORDER LIMITS
- LAND OUTSIDE SCHEME ORDER LIMITS

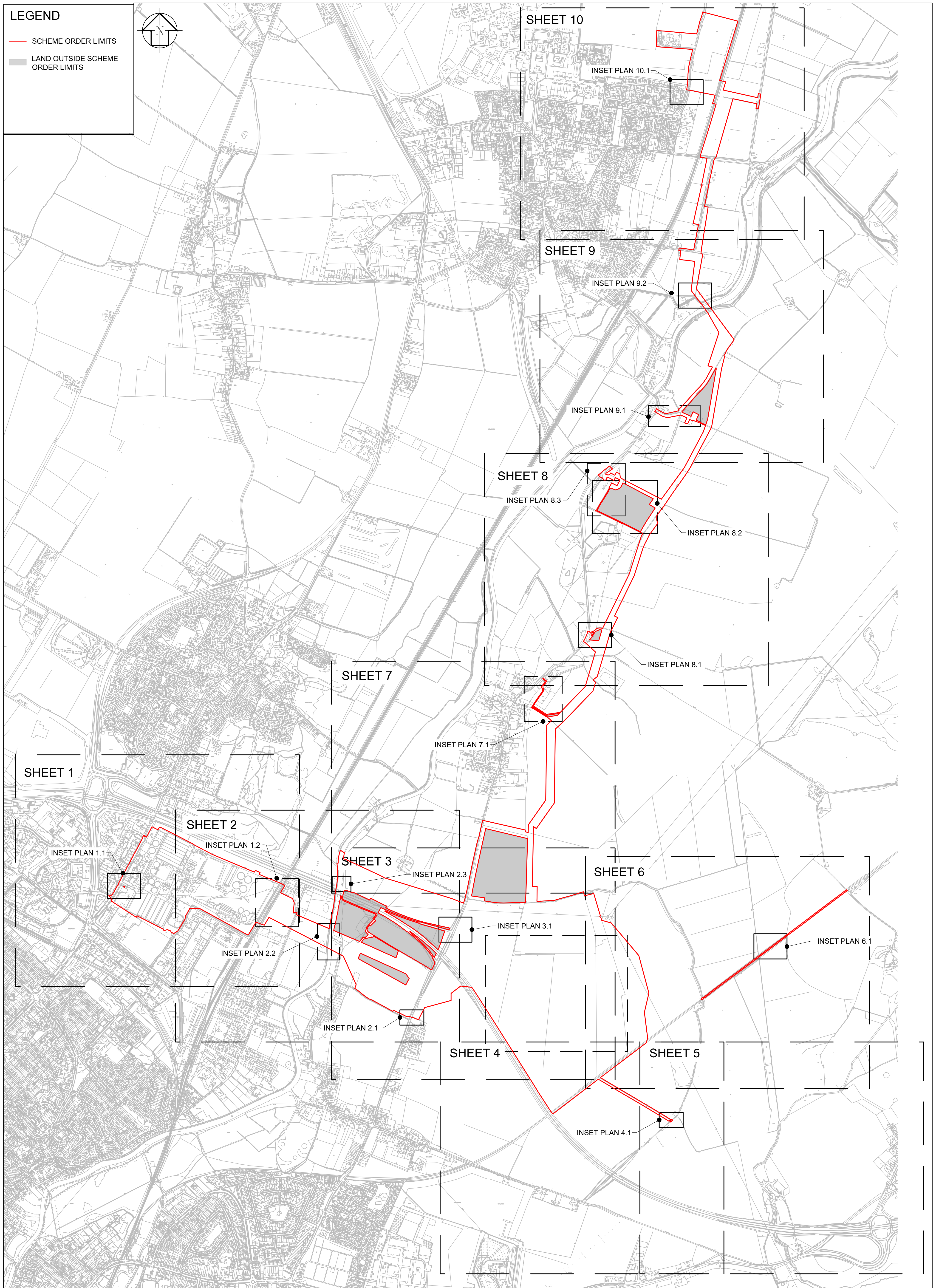
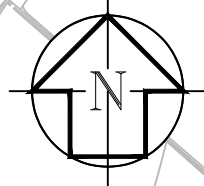

C01	20/01/23	FOR DCO SUBMISSION	S4	JL	MR	MH	DES'D: -	DATE: 20/01/23	DRAWN: JL	DATE: 20/01/23	CHK'D: MR	DATE: 20/01/23	APP'D: MH	DATE: 20/01/23	SCALE: 1:10000	@ A1	SCALE 1:10,000 @A1		
PROJECT TITLE CAMBRIDGE WASTE WATER TREATMENT PLANT RELOCATION PROJECT			DRAWING TITLE 4.8.0 HEDGEROW REGULATIONS & TREE PRESERVATION PLANS - KEY PLAN REGULATION 5(2)(I)(ii) & 5(2)(o)			anglianwater			The plan is produced by Anglian Water Services Limited, from Ordnance Survey Crown Copyright, Licence 100022432. This map is to be used for the purposes of viewing the location of Anglian Water plant only. Any other use of the map data or further copies are not permitted. This notice is not intended to exclude or restrict liability for death or personal injury resulting from negligence. The original document stored in the BIM 360 Doc Project carry the version, suitability code, revision and approval information. Prints are uncontrolled and shall not be used for construction.										A1
DRAWING No. 00001-100006-CAMEST-ZZZ-LAY-Z-9820										REV. STAT. C01 S4									

GENERAL NOTES

1. THESE PLANS SHOULD BE READ IN CONJUNCTION WITH SCHEDULE 15 (REMOVAL OF HEDGEROWS) TO THE DRAFT DEVELOPMENT CONSENT ORDER (APPLICATION DOCUMENT REFERENCE: 2.1) AND THE WORKS PLANS (APPLICATION DOCUMENT REFERENCE: 4.3)
2. THE LEGEND IS IDENTICAL ON ALL SHEETS OF THE HEDGEROW PLANS AND THEREFORE NOT ALL ITEMS DETAILED IN THE LEGEND ARE REPRESENTED ON EACH SHEET.

LEGEND

- SCHEME ORDER LIMITS
- LAND OUTSIDE ORDER LIMITS
- HEDGEROW RETAINED
- HEDGEROW REMOVED
- IMPORTANT HEDGEROW RETAINED
- IMPORTANT HEDGEROW REMOVED
- CONSERVATION AREA BAITS BITE LOCK
- CONSERVATION AREA FEN DITTON
- INDIVIDUAL TREE REMOVED
- H#** START & END POINT OF HEDGEROW TO BE REMOVED

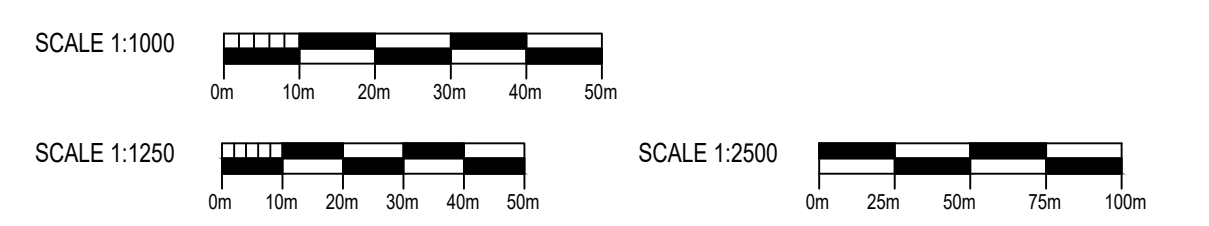
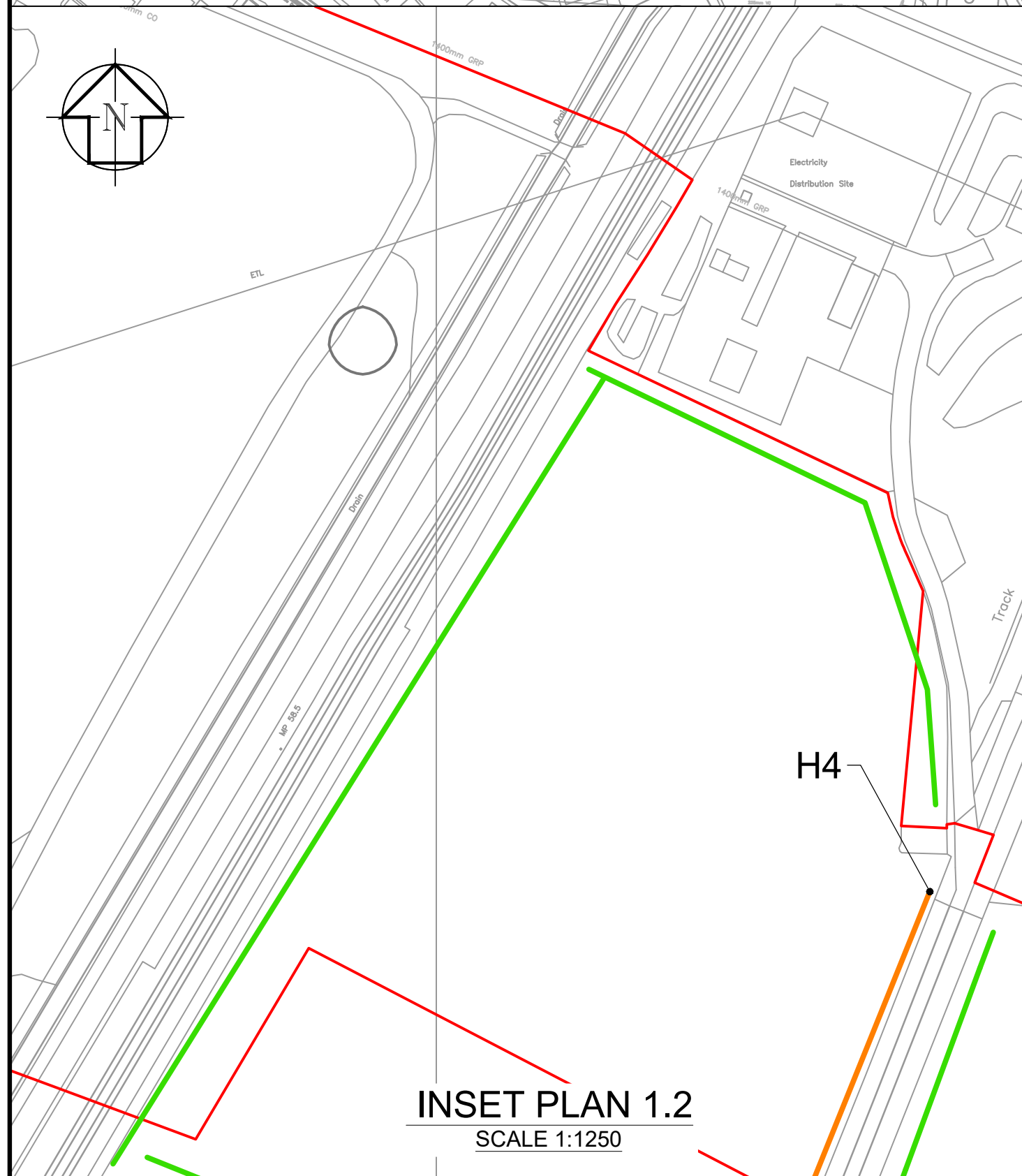
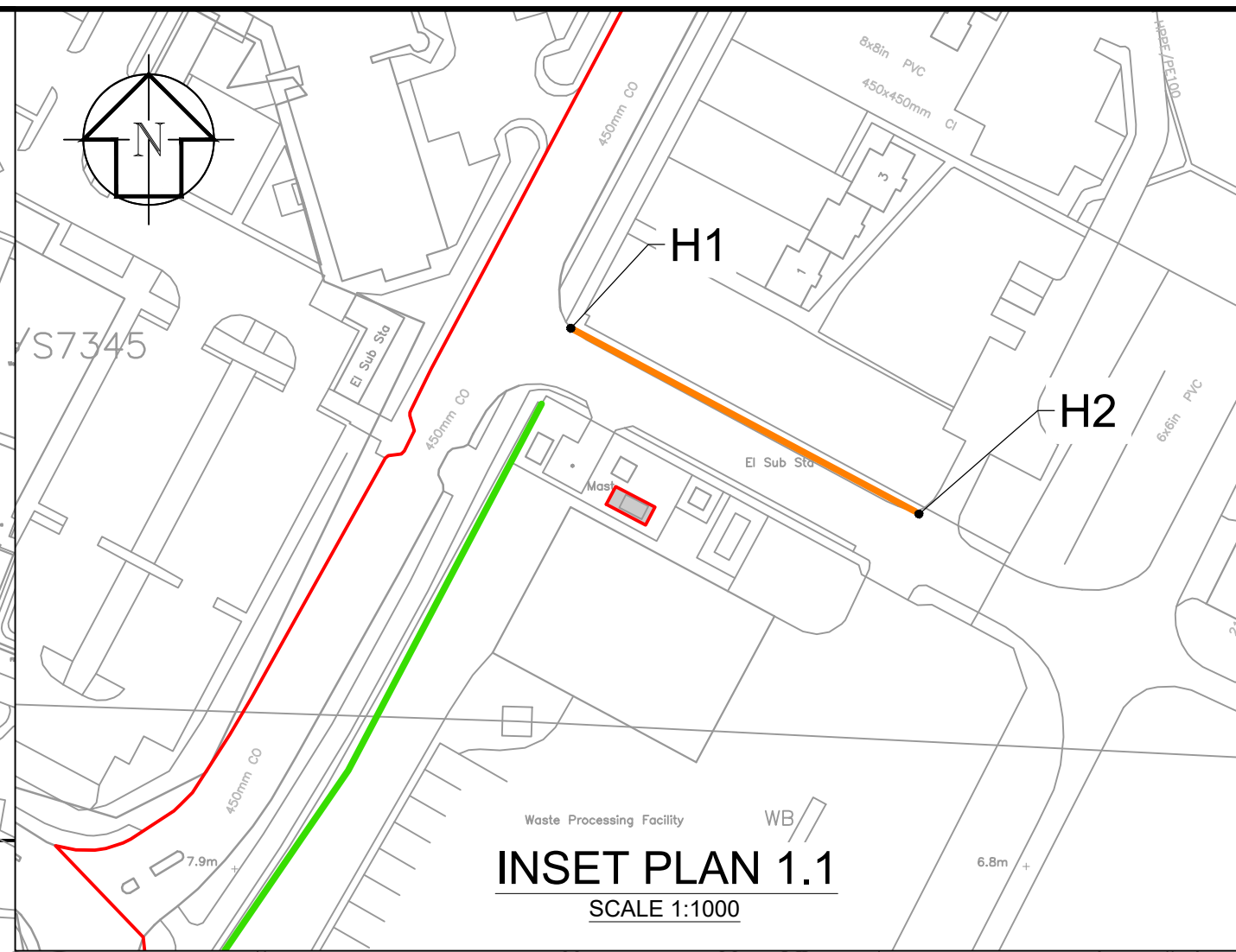
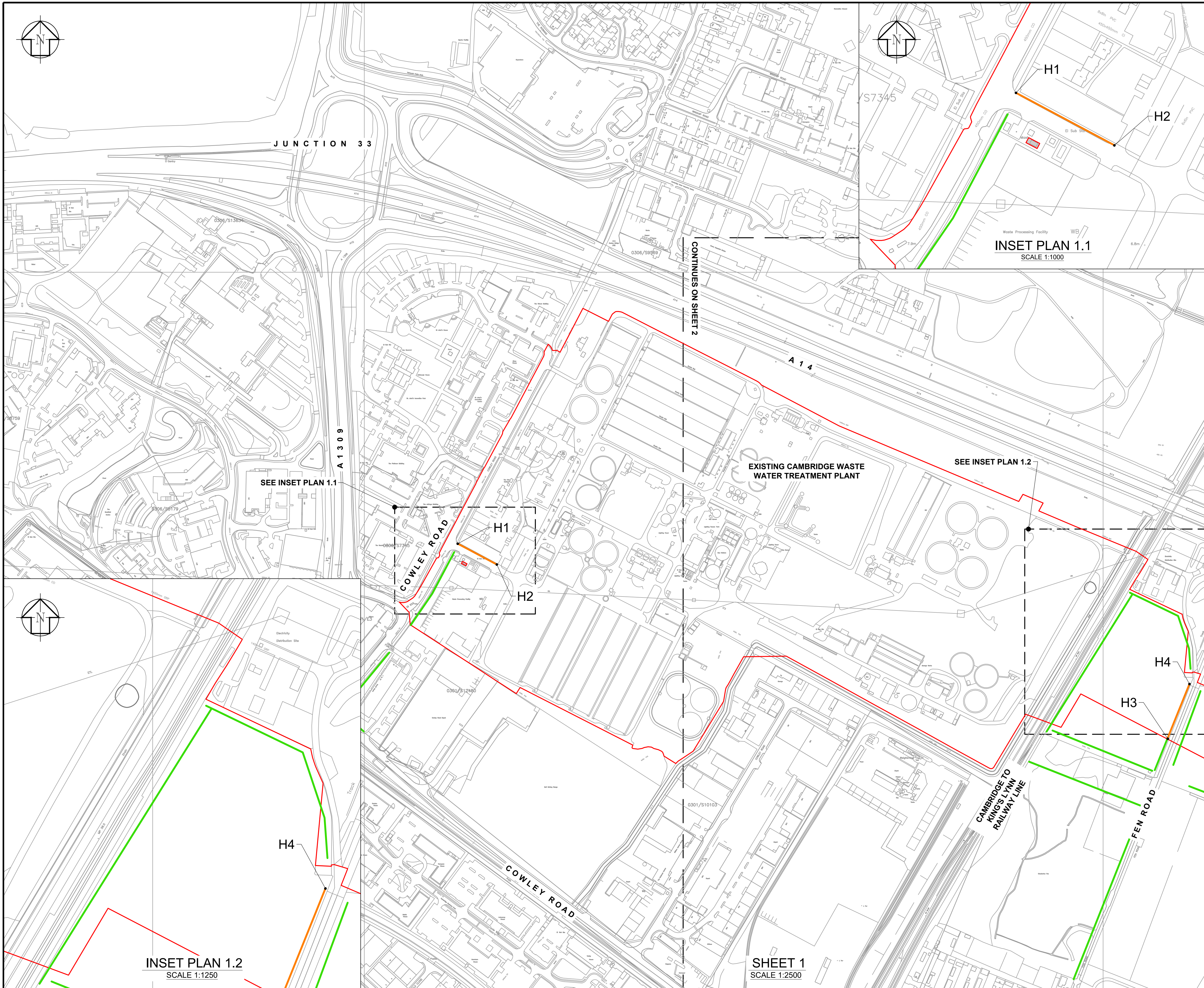

DES'D: -	DATE: 20/01/23	SCALE: AS SHOWN @A1
DRAWN: JL	DATE: 20/01/23	
CHK'D: MR	DATE: 20/01/23	
APP'D: MH	DATE: 20/01/23	
C01 20/01/23 FOR DCO SUBMISSION	S4 JL MR MH	
REV DATE DETAILS	STAT BY CHK APP	

PROJECT TITLE
CAMBRIDGE WASTE WATER TREATMENT PLANT RELOCATION PROJECT

DRAWING TITLE
4.8.1 HEDGEROW REGULATIONS AND TREE PRESERVATION PLANS SHEET 1
 REGULATION 5(2)(I)(ii) & 5(2)(o)



The plan is produced by Anglian Water Services Limited, from Ordnance Survey Crown Copyright, Licence 100022432. This map is to be used for the purposes of viewing the location of Anglian Water plant only. Any other use of the map data or further copies are not permitted. This notice is not intended to exclude or restrict liability for death or personal injury resulting from negligence. The original document stored in the BIM 360 Doc Project carry the version, suitability code, revision and approval information. Prints are uncontrolled and shall not be used for construction.

DRAWING No. **00001-100006-CAMEST-ZZZ-LAY-Z-9021**

REV. STAT. **A1**
C01 S4

GENERAL NOTES

1. THESE PLANS SHOULD BE READ IN CONJUNCTION WITH SCHEDULE 15 (REMOVAL OF HEDGEROWS) TO THE DRAFT DEVELOPMENT CONSENT ORDER (APPLICATION DOCUMENT REFERENCE: 2.1) AND THE WORKS PLANS (APPLICATION DOCUMENT REFERENCE: 4.3)
2. THE LEGEND IS IDENTICAL ON ALL SHEETS OF THE HEDGEROW PLANS AND THEREFORE NOT ALL ITEMS DETAILED IN THE LEGEND ARE REPRESENTED ON EACH SHEET.

LEGEND

- SCHEME ORDER LIMITS
- LAND OUTSIDE ORDER LIMITS
- HEDGEROW RETAINED
- HEDGEROW REMOVED
- IMPORTANT HEDGEROW RETAINED
- IMPORTANT HEDGEROW REMOVED
- CONSERVATION AREA BAITS BITE LOCK
- CONSERVATION AREA FEN DITTON
- INDIVIDUAL TREE REMOVED
- H#** START & END POINT OF HEDGEROW TO BE REMOVED

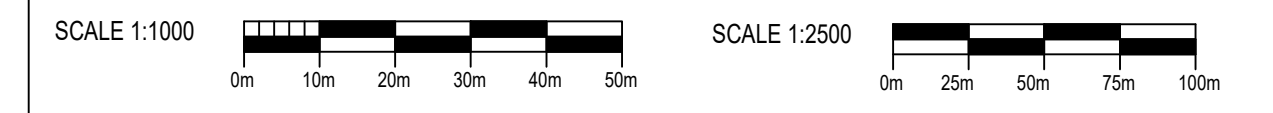
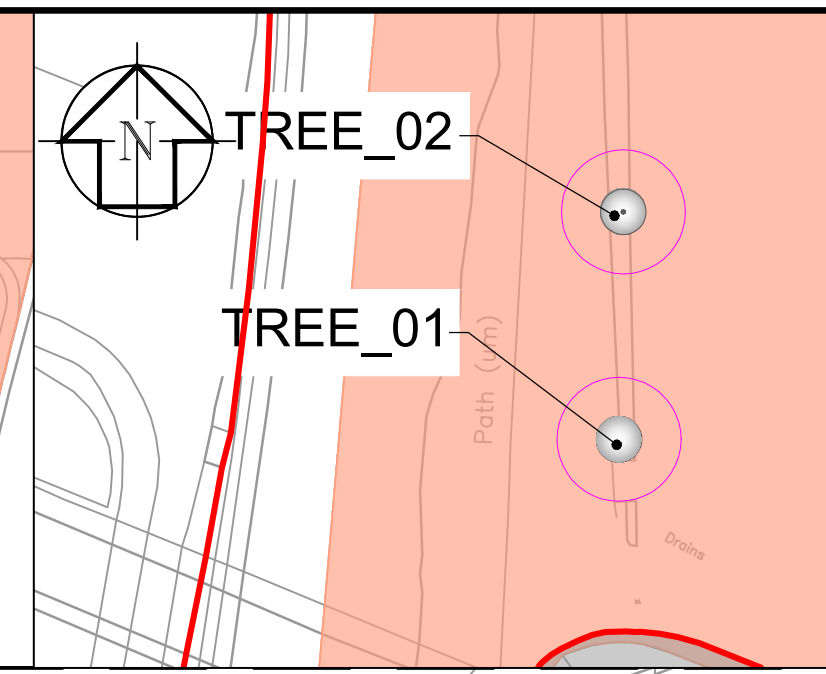
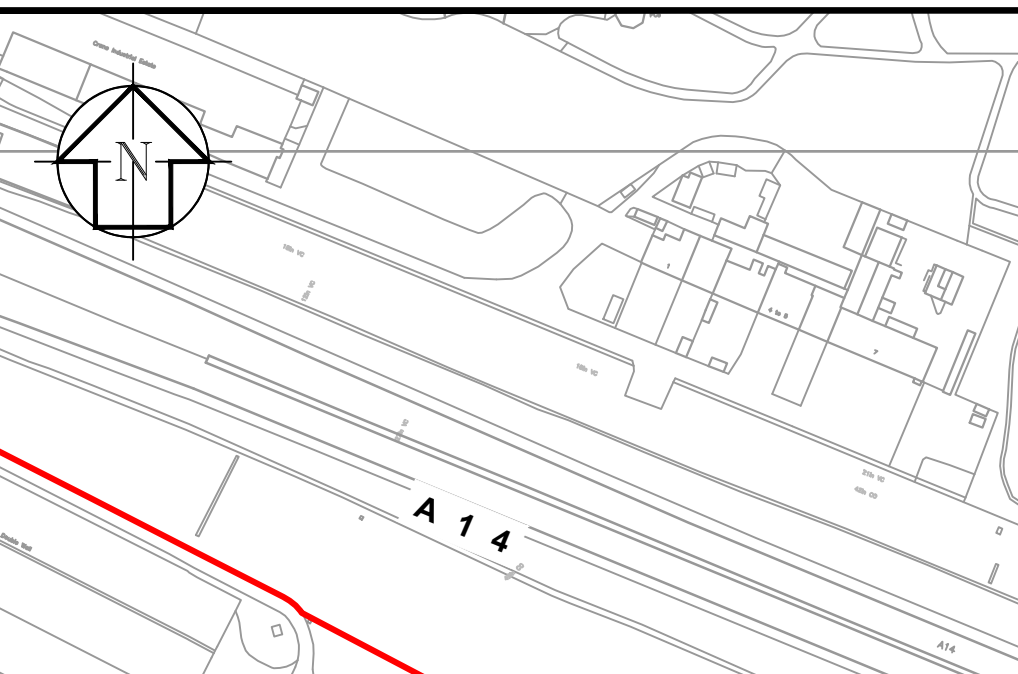
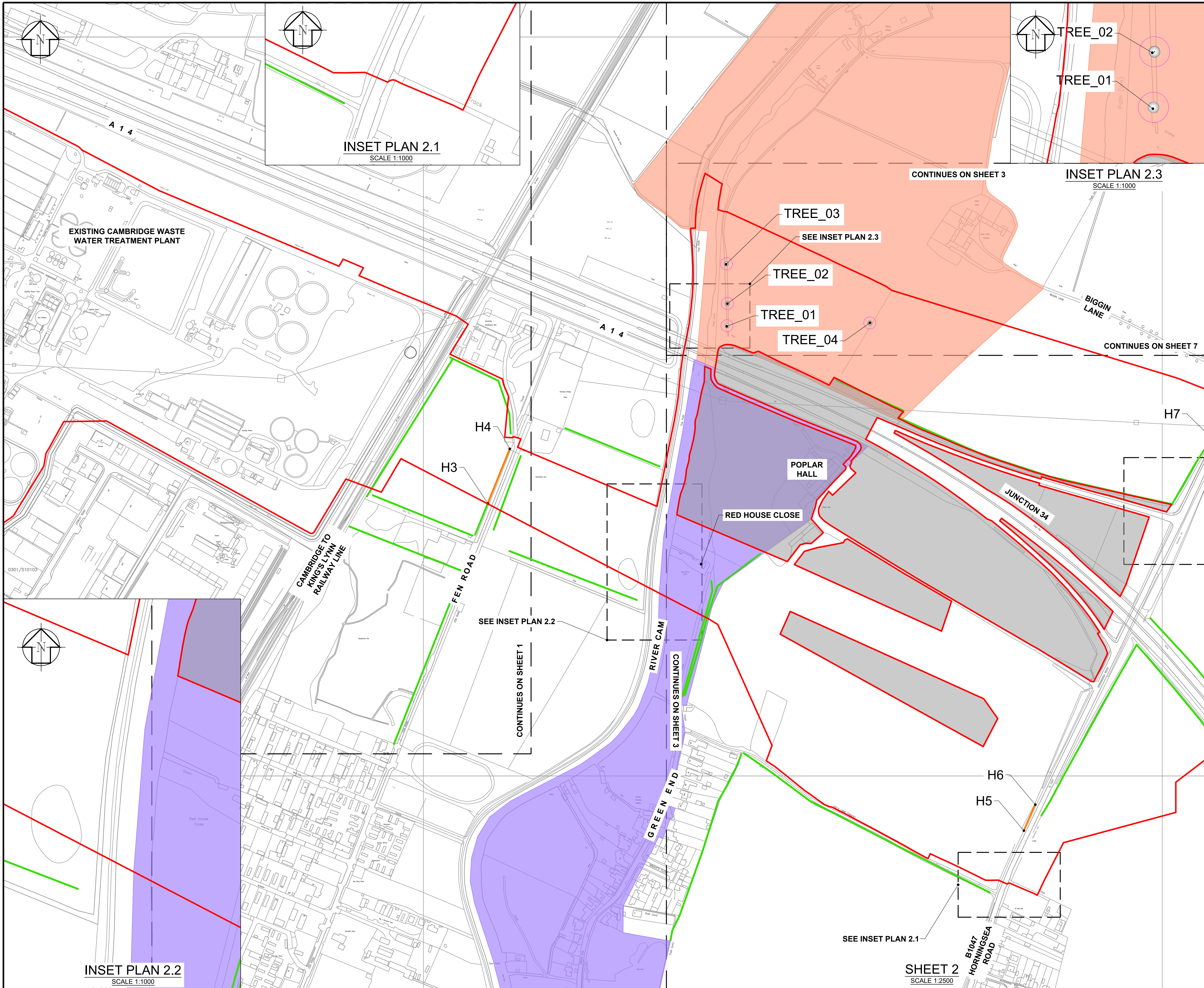

DES'D: -	DATE: 20/01/23	SCALE: AS SHOWN @A1
DRAWN: JL	DATE: 20/01/23	
CHK'D: MR	DATE: 20/01/23	
APP'D: MH	DATE: 20/01/23	
REV	DATE	DETAILS
C01	20/01/23	FOR DCO SUBMISSION
		S4 JL MR MH
		STAT BY CHK APP

PROJECT TITLE
CAMBRIDGE WASTE WATER TREATMENT PLANT RELOCATION PROJECT

DRAWING TITLE
4.8.2 HEDGEROW REGULATIONS AND TREE PRESERVATION PLANS SHEET 2
 REGULATION 5(2)(I)(ii) & 5(2)(o)



The plan is produced by Anglian Water Services Limited, from Ordnance Survey Crown Copyright, Licence 100022432. This map is to be used for the purposes of viewing the location of Anglian Water plant only. Any other use of the map data or further copies are not permitted. This notice is not intended to exclude or restrict liability for death or personal injury resulting from negligence. The original document stored in the BIM 360 Doc Project carry the version, suitability code, revision and approval information. Prints are uncontrolled and shall not be used for construction.

DRAWING No. **00001-100006-CAMEST-ZZZ-LAY-Z-9022**

DRAWING SIZE: **A1**

REV. STAT. **C01 S4**

GENERAL NOTES

1. THESE PLANS SHOULD BE READ IN CONJUNCTION WITH SCHEDULE 15 (REMOVAL OF HEDGEROWS) TO THE DRAFT DEVELOPMENT CONSENT ORDER (APPLICATION DOCUMENT REFERENCE: 2.1) AND THE WORKS PLANS (APPLICATION DOCUMENT REFERENCE: 4.3)
2. THE LEGEND IS IDENTICAL ON ALL SHEETS OF THE HEDGEROW PLANS AND THEREFORE NOT ALL ITEMS DETAILED IN THE LEGEND ARE REPRESENTED ON EACH SHEET.

LEGEND

- SCHEME ORDER LIMITS
- LAND OUTSIDE ORDER LIMITS
- HEDGEROW RETAINED
- HEDGEROW REMOVED
- IMPORTANT HEDGEROW RETAINED
- IMPORTANT HEDGEROW REMOVED
- CONSERVATION AREA BAITS BITE LOCK
- CONSERVATION AREA FEN DITTON
- o INDIVIDUAL TREE REMOVED
- H#** START & END POINT OF HEDGEROW TO BE REMOVED

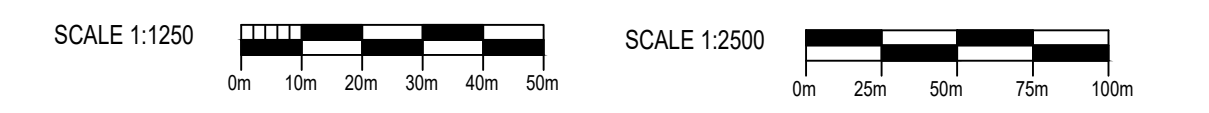
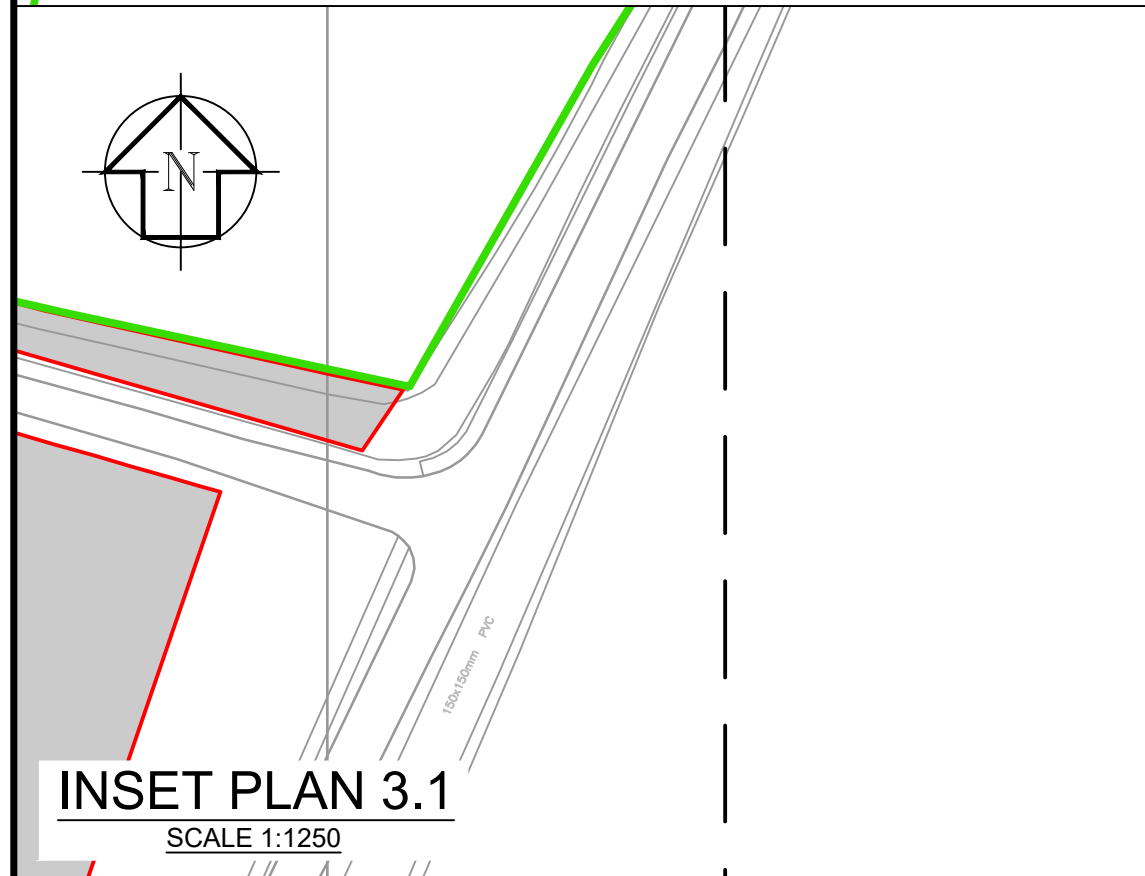
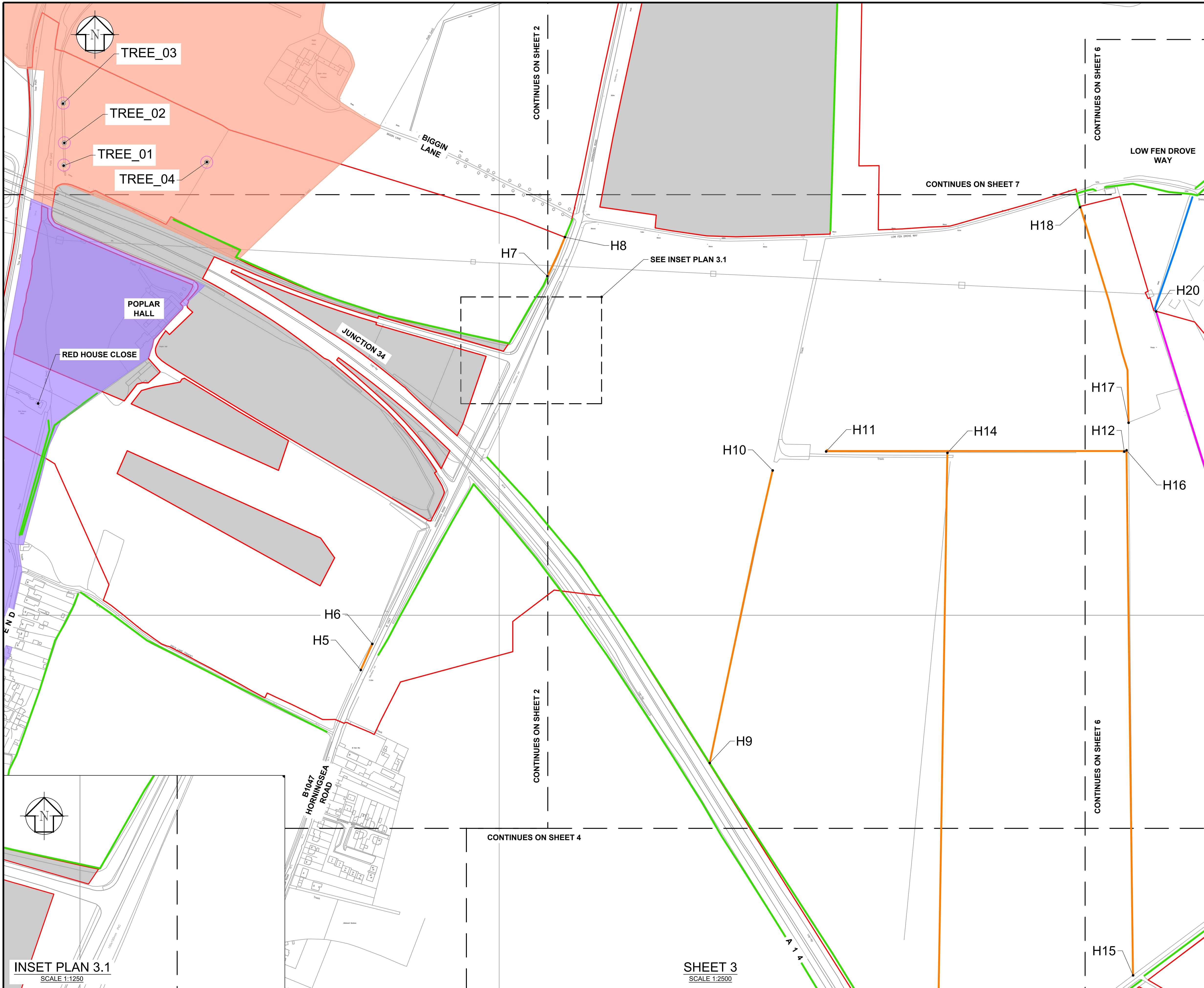

DES'D: -	DATE: 20/01/23	SCALE: AS SHOWN @A1
DRAWN: JL	DATE: 20/01/23	
CHK'D: MR	DATE: 20/01/23	
APP'D: MH	DATE: 20/01/23	
REV	DATE	DETAILS
C01	20/01/23	FOR DCO SUBMISSION
		S4 JL MR MH
		STAT BY CHK APP

PROJECT TITLE
CAMBRIDGE WASTE WATER TREATMENT PLANT RELOCATION PROJECT

DRAWING TITLE
4.8.3 HEDGEROW REGULATIONS AND TREE PRESERVATION PLANS SHEET 3 REGULATION 5(2)(I)(ii) & 5(2)(o)



The plan is produced by Anglian Water Services Limited, from Ordnance Survey Crown Copyright, Licence 100022432. This map is to be used for the purposes of viewing the location of Anglian Water plant only. Any other use of the map data or further copies are not permitted. This notice is not intended to exclude or restrict liability for death or personal injury resulting from negligence. The original document stored in the BIM 360 Doc Project carry the version, suitability code, revision and approval information. Prints are uncontrolled and shall not be used for construction.

DRAWING No. **00001-100006-CAMEST-ZZZ-LAY-Z-9023**

REV. STAT. **A1**
C01 S4

APPLICATION DOCUMENT REFERENCE 4.8.4

GENERAL NOTES

1. THESE PLANS SHOULD BE READ IN CONJUNCTION WITH SCHEDULE 15 (REMOVAL OF HEDGEROWS) TO THE DRAFT DEVELOPMENT CONSENT ORDER (APPLICATION DOCUMENT REFERENCE: 2.1) AND THE WORKS PLANS (APPLICATION DOCUMENT REFERENCE: 4.3)
2. THE LEGEND IS IDENTICAL ON ALL SHEETS OF THE HEDGEROW PLANS AND THEREFORE NOT ALL ITEMS DETAILED IN THE LEGEND ARE REPRESENTED ON EACH SHEET.

LEGEND

- SCHEME ORDER LIMITS
- LAND OUTSIDE ORDER LIMITS
- HEDGEROW RETAINED
- HEDGEROW REMOVED
- IMPORTANT HEDGEROW RETAINED
- IMPORTANT HEDGEROW REMOVED
- CONSERVATION AREA BAITS BITE LOCK
- CONSERVATION AREA FEN DITTON
- INDIVIDUAL TREE REMOVED
- H#** START & END POINT OF HEDGEROW TO BE REMOVED

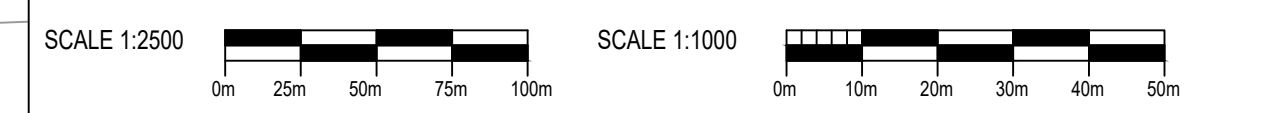
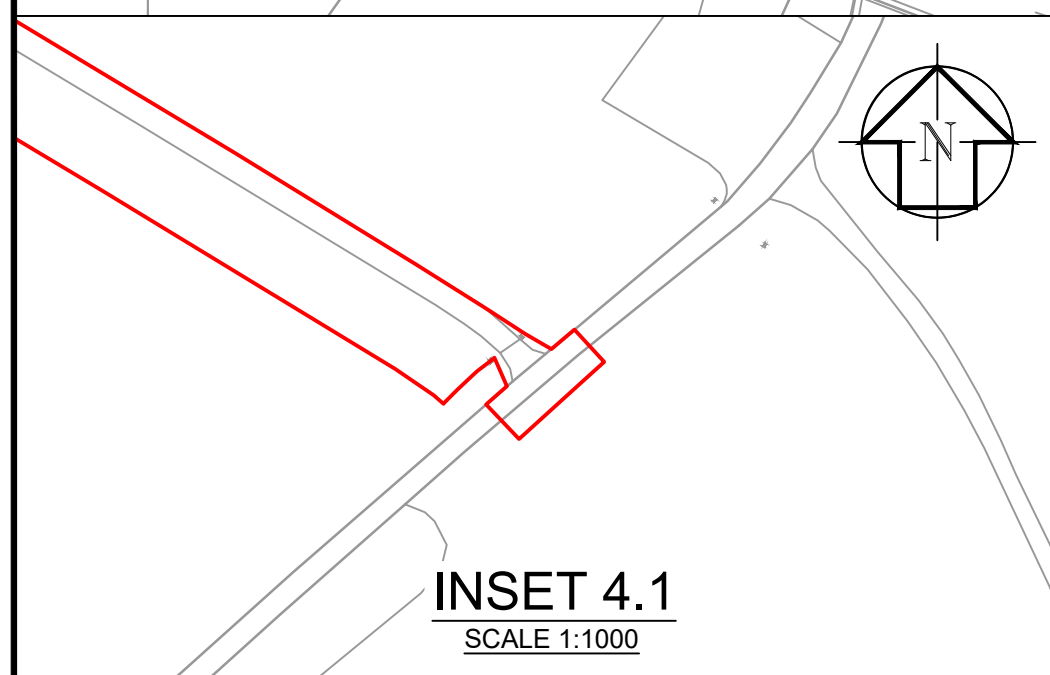
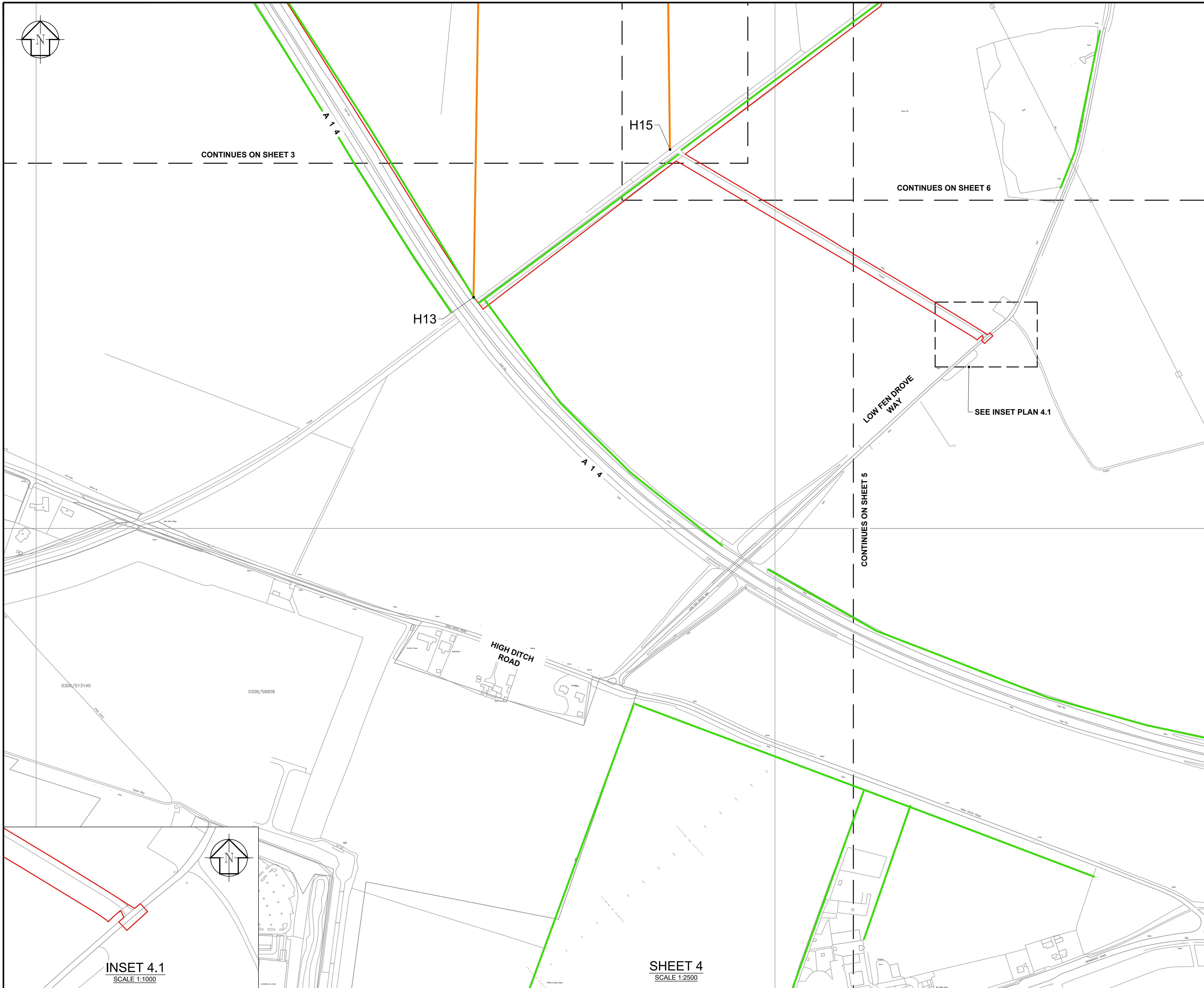

DES'D: -	DATE: 20/01/23	SCALE: AS SHOWN @A1
DRAWN: JL	DATE: 20/01/23	
CHK'D: MR	DATE: 20/01/23	
APP'D: MH	DATE: 20/01/23	
REV	DATE	DETAILS
C01	20/01/23	FOR DCO SUBMISSION
		S4 JL MR MH
		STAT BY CHK APP

PROJECT TITLE
CAMBRIDGE WASTE WATER TREATMENT PLANT RELOCATION PROJECT

DRAWING TITLE
4.8.4 HEDGEROW REGULATIONS AND TREE PRESERVATION PLANS SHEET 4
 REGULATION 5(2)(I)(ii) & 5(2)(o)



The plan is produced by Anglian Water Services Limited, from Ordnance Survey Crown Copyright, Licence 100022432. This map is to be used for the purposes of viewing the location of Anglian Water plant only. Any other use of the map data or further copies are not permitted. This notice is not intended to exclude or restrict liability for death or personal injury resulting from negligence. The original document stored in the BIM 360 Doc Project carry the version, suitability code, revision and approval information. Prints are uncontrolled and shall not be used for construction.

DRAWING No. **00001-100006-CAMEST-ZZZ-LAY-Z-9024**

REV. STAT. **A1**
C01 S4

GENERAL NOTES

1. THESE PLANS SHOULD BE READ IN CONJUNCTION WITH SCHEDULE 15 (REMOVAL OF HEDGEROWS) TO THE DRAFT DEVELOPMENT CONSENT ORDER (APPLICATION DOCUMENT REFERENCE: 2.1) AND THE WORKS PLANS (APPLICATION DOCUMENT REFERENCE: 4.3)
2. THE LEGEND IS IDENTICAL ON ALL SHEETS OF THE HEDGEROW PLANS AND THEREFORE NOT ALL ITEMS DETAILED IN THE LEGEND ARE REPRESENTED ON EACH SHEET.

LEGEND

- SCHEME ORDER LIMITS
- LAND OUTSIDE ORDER LIMITS
- HEDGEROW RETAINED
- HEDGEROW REMOVED
- IMPORTANT HEDGEROW RETAINED
- IMPORTANT HEDGEROW REMOVED
- CONSERVATION AREA BAITS BITE LOCK
- CONSERVATION AREA FEN DITTON
- INDIVIDUAL TREE REMOVED
- H#** START & END POINT OF HEDGEROW TO BE REMOVED

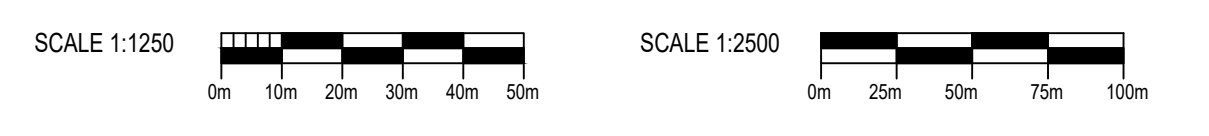
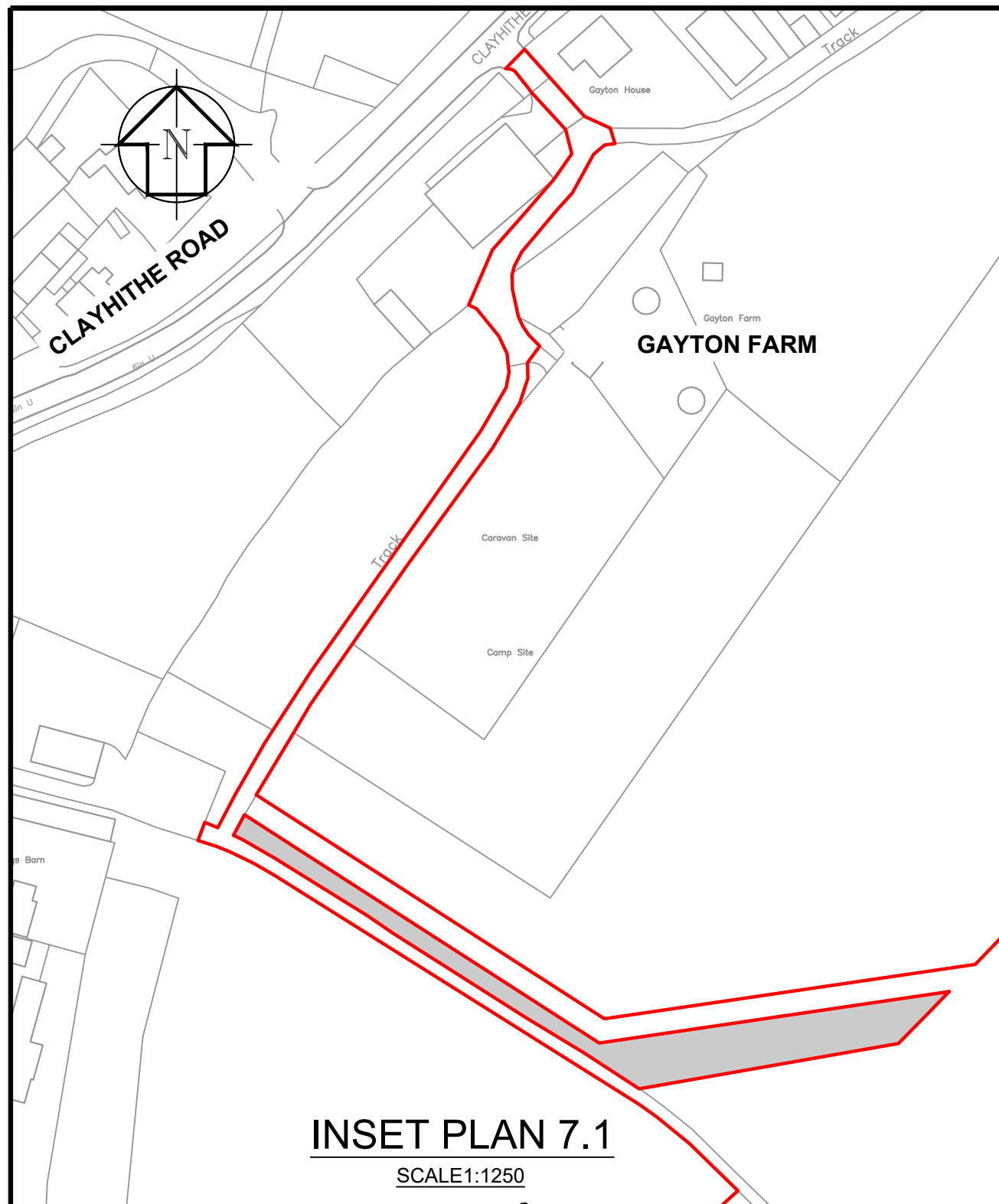
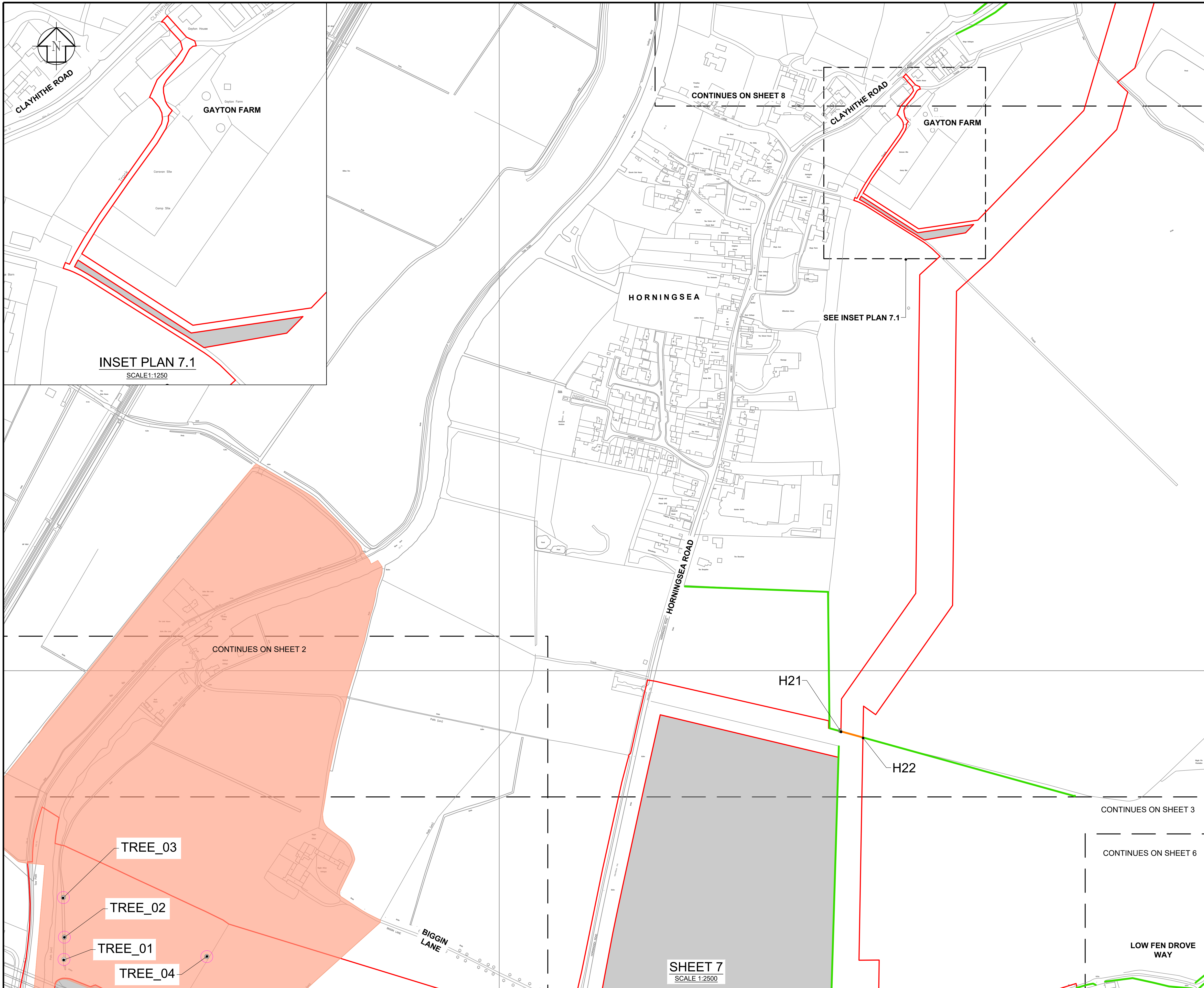

DES'D: -	DATE: 20/01/23	SCALE: AS SHOWN @A1
DRAWN: JL	DATE: 20/01/23	
CHK'D: MR	DATE: 20/01/23	
APP'D: MH	DATE: 20/01/23	
C01	20/01/23	FOR DCO SUBMISSION
REV	DATE	DETAILS
	STAT BY	CHK APP

PROJECT TITLE
CAMBRIDGE WASTE WATER TREATMENT PLANT RELOCATION PROJECT

DRAWING TITLE
4.8.7 HEDGEROW REGULATIONS AND TREE PRESERVATION PLANS SHEET 7 REGULATION 5(2)(I)(ii) & 5(2)(o)



The plan is produced by Anglian Water Services Limited, from Ordnance Survey Crown Copyright, Licence 100022432. This map is to be used for the purposes of viewing the location of Anglian Water plant only. Any other use of the map data or further copies are not permitted. This notice is not intended to exclude or restrict liability for death or personal injury resulting from negligence. The original document stored in the BIM 360 Doc Project carry the version, suitability code, revision and approval information. Prints are uncontrolled and shall not be used for construction.

DRAWING No. **00001-100006-CAMEST-ZZZ-LAY-Z-9027**

REV. STAT. **A1**
C01 S4

GENERAL NOTES

1. THESE PLANS SHOULD BE READ IN CONJUNCTION WITH SCHEDULE 15 (REMOVAL OF HEDGEROWS) TO THE DRAFT DEVELOPMENT CONSENT ORDER (APPLICATION DOCUMENT REFERENCE: 2.1) AND THE WORKS PLANS (APPLICATION DOCUMENT REFERENCE: 4.3)
2. THE LEGEND IS IDENTICAL ON ALL SHEETS OF THE HEDGEROW PLANS AND THEREFORE NOT ALL ITEMS DETAILED IN THE LEGEND ARE REPRESENTED ON EACH SHEET.

LEGEND

- SCHEME ORDER LIMITS
- LAND OUTSIDE ORDER LIMITS
- HEDGEROW RETAINED
- HEDGEROW REMOVED
- IMPORTANT HEDGEROW RETAINED
- IMPORTANT HEDGEROW REMOVED
- CONSERVATION AREA BAITS BITE LOCK
- CONSERVATION AREA FEN DITTON
- o INDIVIDUAL TREE REMOVED
- H#** START & END POINT OF HEDGEROW TO BE REMOVED

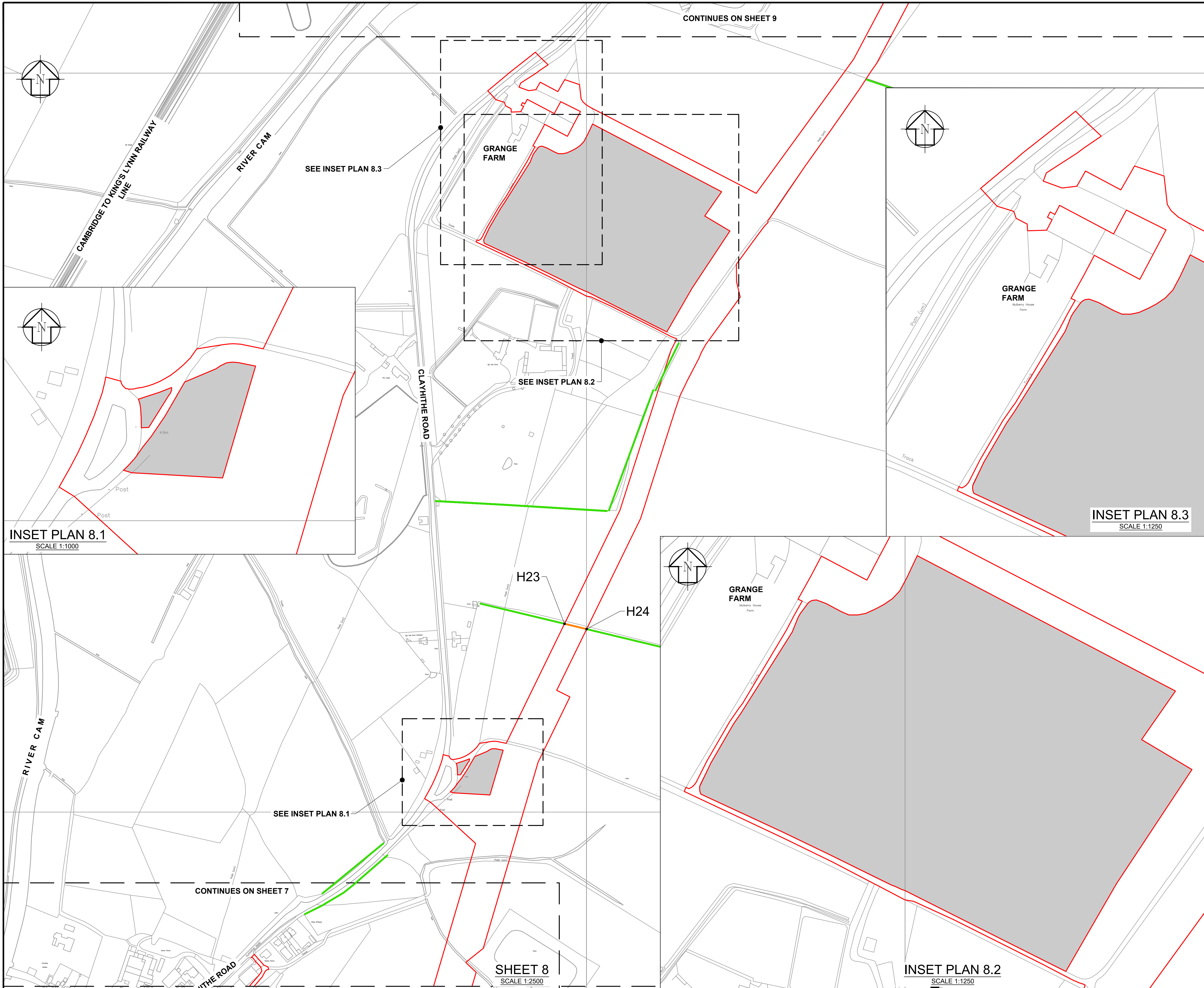

INSET PLAN 8.1
SCALE 1:1000

INSET PLAN 8.3
SCALE 1:1250

INSET PLAN 8.2
SCALE 1:1250

SHEET 8
SCALE 1:2500

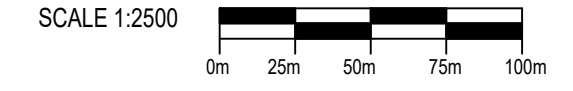
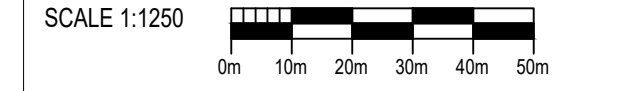
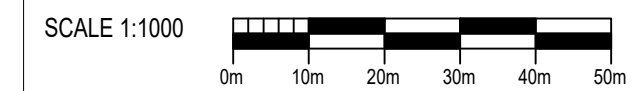

DES'D: -	DATE: 20/01/23	SCALE: AS SHOWN @A1
DRAWN: JL	DATE: 20/01/23	
CHK'D: MR	DATE: 20/01/23	
APP'D: MH	DATE: 20/01/23	
C01 20/01/23 FOR DCO SUBMISSION	S4 JL MR MH	
REV DATE DETAILS	STAT BY CHK APP	

PROJECT TITLE
CAMBRIDGE WASTE WATER TREATMENT PLANT RELOCATION PROJECT

DRAWING TITLE
4.8.8 HEDGEROW REGULATIONS AND TREE PRESERVATION PLANS SHEET 8 REGULATION 5(2)(I)(ii) & 5(2)(o)



The plan is produced by Anglian Water Services Limited, from Ordnance Survey Crown Copyright, Licence 100022432. This map is to be used for the purposes of viewing the location of Anglian Water plant only. Any other use of the map data or further copies are not permitted. This notice is not intended to exclude or restrict liability for death or personal injury resulting from negligence. The original document stored in the BIM 360 Doc Project carry the version, suitability code, revision and approval information. Prints are uncontrolled and shall not be used for construction.

DRAWING No. **00001-100006-CAMEST-ZZZ-LAY-Z-9028**

DRAWING SIZE: **A1**

REV. STAT. **C01 S4**

GENERAL NOTES

1. THESE PLANS SHOULD BE READ IN CONJUNCTION WITH SCHEDULE 15 (REMOVAL OF HEDGEROWS) TO THE DRAFT DEVELOPMENT CONSENT ORDER (APPLICATION DOCUMENT REFERENCE: 2.1) AND THE WORKS PLANS (APPLICATION DOCUMENT REFERENCE: 4.3)
2. THE LEGEND IS IDENTICAL ON ALL SHEETS OF THE HEDGEROW PLANS AND THEREFORE NOT ALL ITEMS DETAILED IN THE LEGEND ARE REPRESENTED ON EACH SHEET.

LEGEND

- SCHEME ORDER LIMITS
- LAND OUTSIDE ORDER LIMITS
- HEDGEROW RETAINED
- HEDGEROW REMOVED
- IMPORTANT HEDGEROW RETAINED
- IMPORTANT HEDGEROW REMOVED
- CONSERVATION AREA BAITS BITE LOCK
- CONSERVATION AREA FEN DITTON
- INDIVIDUAL TREE REMOVED
- H#** START & END POINT OF HEDGEROW TO BE REMOVED

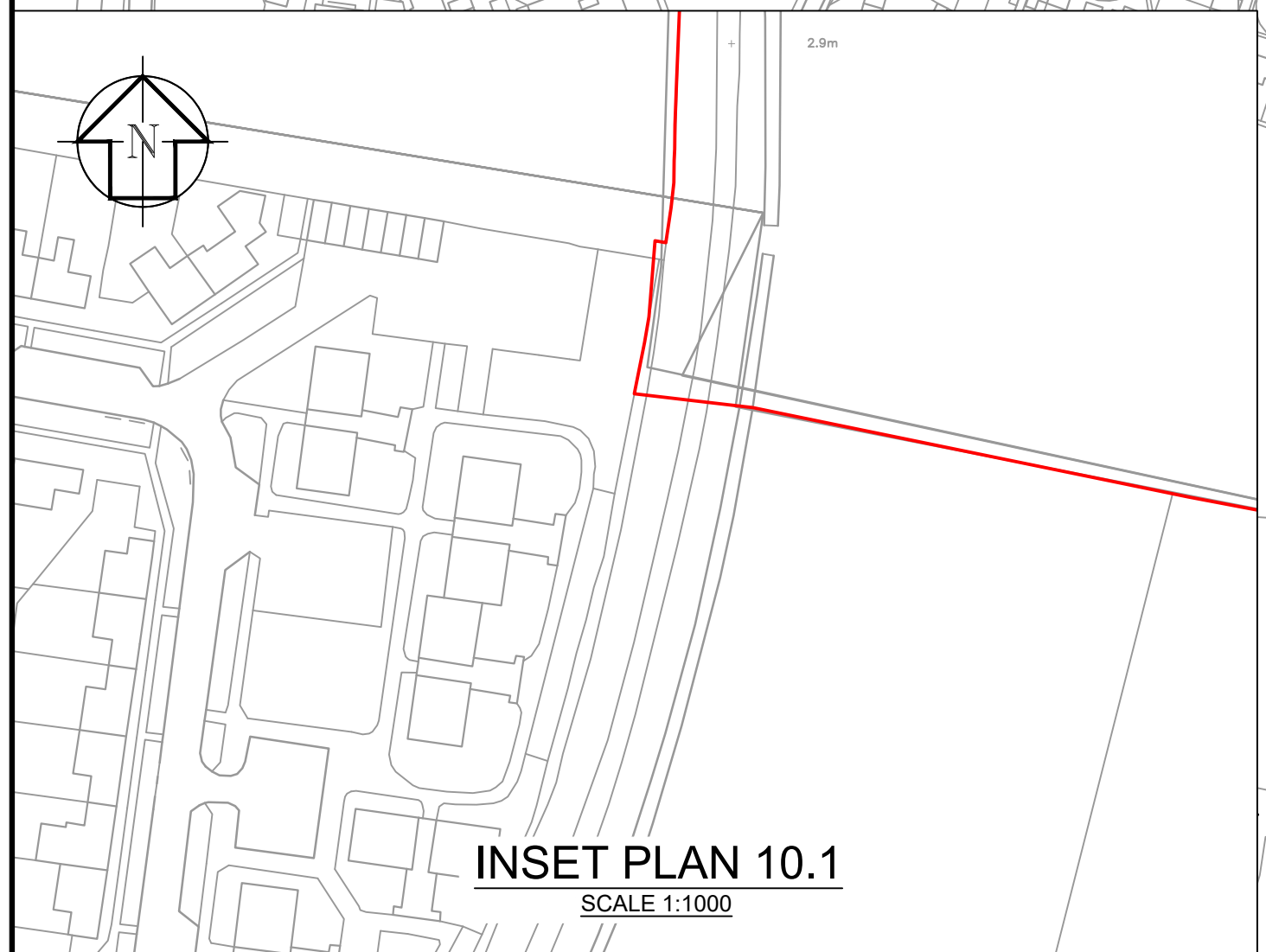
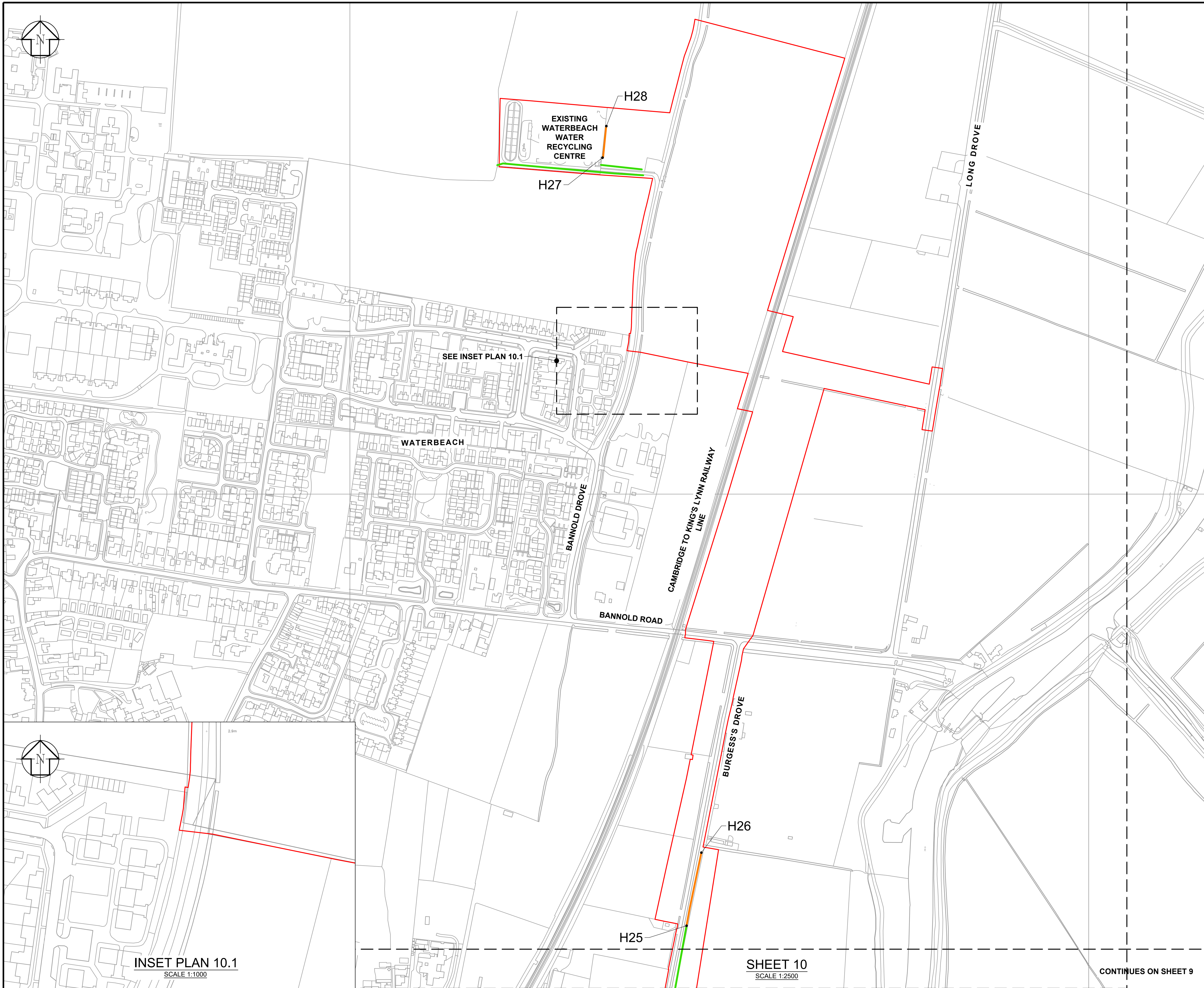

INSET PLAN 10.1
SCALE 1:1000

SHEET 10
SCALE 1:2500

CONTINUES ON SHEET 9

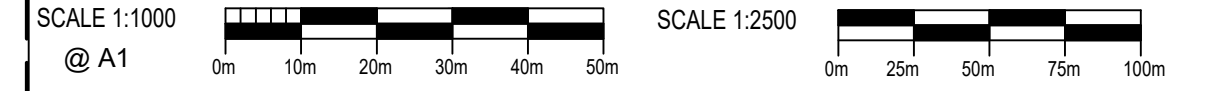

DES'D: -	DATE: 20/01/23	SCALE: AS SHOWN @A1	PROJECT TITLE	DRAWING TITLE		The plan is produced by Anglian Water Services Limited, from Ordnance Survey Crown Copyright, Licence 100022432. This map is to be used for the purposes of viewing the location of Anglian Water plant only. Any other use of the map data or further copies are not permitted. This notice is not intended to exclude or restrict liability for death or personal injury resulting from negligence. The original document stored in the BIM 360 Doc Project carry the version, suitability code, revision and approval information. Prints are uncontrolled and shall not be used for construction.	DRAWING No. 00001-100006-CAMEST-ZZZ-LAY-Z-9030	REV. STAT. C01 S4
DRAWN: JL	DATE: 20/01/23		CAMBRIDGE WASTE WATER TREATMENT PLANT RELOCATION PROJECT	4.8.10 HEDGEROW REGULATIONS AND TREE PRESERVATION PLANS SHEET 10 REGULATION 5(2)(I)(ii) & 5(2)(o)				
CHK'D: MR	DATE: 20/01/23							
APP'D: MH	DATE: 20/01/23							
C01	20/01/23	FOR DCO SUBMISSION	S4	JL	MR	MH		
REV	DATE	DETAILS	STAT	BY	CHK	APP		

PROJECT TITLE
CAMBRIDGE WASTE WATER TREATMENT PLANT RELOCATION PROJECT

DRAWING TITLE
4.8.10 HEDGEROW REGULATIONS AND TREE PRESERVATION PLANS SHEET 10 REGULATION 5(2)(I)(ii) & 5(2)(o)

anglianwater

Anglian Water Services Ltd, Lancaster House, Lancaster Way, Ermine Business Park, Huntingdon, PE29 6XU
Tel: 01480 323000 www.anglianwater.co.uk

SCALE 1:1000 @ A1

SCALE 1:2500

00001-100006-CAMEST-ZZZ-LAY-Z-9030

REV. STAT.
C01 S4

Get in touch

You can contact us by:



Emailing at info@cwwtpr.com



Calling our Freephone information line on **0808 196 1661**



Writing to us at **Freepost: CWWTPR**



Visiting our website at 

You can view all our DCO application documents and updates on the application on The Planning Inspectorate website:

<https://infrastructure.planninginspectorate.gov.uk/projects/eastern/cambridge-waste-water-treatment-plant-relocation/>